

Doors – Technical Guide

Contents

1	Introduction	1
1.1	Our Doors	1
1.2	Types of Door	2
2	Specification	2
2.1	Paint Finish	2
2.2	Draught Proofing	3
2.3	Glazing	3
2.4	Ironmongery	5
3	Section Details	5
3.1	Front Doors	6
3.2	Single and French Doors	8
3.3	Bifolding Doors	10

1 Introduction

We manufacture all of our windows & doors in-house. We are constantly improving our procedures & processes to ensure the highest quality finish. We have made significant investment to bring large portions of the production process in-house, meaning that when you engage our services everything from the measurements, to the machining, joining, painting, manufacture of glazing and installation will all be done by a member of staff who is employed by our company.

1.1 Our Doors

We have spent years honing the design and quality of our windows & doors to bring us to the point now where, we believe, we can offer our customers the highest quality product combining aesthetics, traditional styles, security, insulation, longevity and more.

The specifications set out in this document have been refined over the years, with decades of experience going into the final designs.

One of the most important considerations in these designs is the longevity of the products. We understand that replacing your windows is a costly endeavour and our customers would not want to be replacing the same window every 10 years.

Wandsworth Sash Windows is a trading name of Sanford Group Limited
 Company Reg. No.: 10550497 VAT Reg. No.: 263 2750 10
 Directors: N Smith M Smith T Smith

We also take traditional designs & styles into account when manufacturing windows & doors, trying to ensure replacement windows are as sympathetic to traditional styles as possible.

Some parts of your new windows may not be the same as your original. This is because we need to combine all of these considerations to ensure we provide the highest quality window, which is exactly what we do.

1.2 Types of Door

Our doors can generally be split into three types:

- ❖ Front Door – Traditionally opening inwards and with a deadlock & nightlatch locking mechanism. Often with a mix of timber and glass panels.
- ❖ Single & French Doors – Traditionally opening outwards and now fitted with a multipoint locking mechanism.
- ❖ Bifolding Doors – A modern mechanism for doors that has become popular in extensions to create a big opening from inside to outside.

Most of our doors are manufactured to standard section dimensions and details. We also have a variety of options within these standard details.

If specialist, unique or completely bespoke details or sections are required, then this is no issue for us. If you require something completely bespoke, you should advise a member of our team about this and they will put you in touch with one of our CAD designers who will work with you to provide a quotation for your bespoke details.

Unless otherwise specified on your quotation or Order Confirmation, your order will be produced to our standard sectional and technical details set out in this document.

2 Specification

2.1 Paint Finish

We apply the following coats to all joinery¹:

- Two coats of primer base coats
- One coat of top coat

We have found that the best paint system available is Teknos, giving the best possible coating & protection of the timber.

Paint Colour	Finish	Specification
Primer	N/A	Teknos Antique White Anti Stain Aqua 2901 Isolating Primer
White	Gloss	Teknos Aquatop 2600 Clean White Gloss Opaque Top Coat
White	Satin	Teknos Aquatop 2600 Clean White Semi Matt Opaque Top Coat
Colour Match	Gloss	Teknos Aquatop 2600 Colour Match Gloss Opaque Top Coat

¹ Unless otherwise specified on a Quotation or Order Confirmation.

Colour Match	Satin	Teknos Aquatop 2600 Colour Match Semi Matt Opaque Top Coat
--------------	-------	---

White gloss and white satin paint with a single finish on each item are included as standard.

Dual finish of white gloss & white satin paint, and colour matches are an optional extra.

Any custom paint finish specified, such as Farrow & Ball or Dulux, will be colour matched by Teknos¹.

2.2 Draught Proofing

As doors are designed to open in and out, the best form of draught sealing is a compression seal. Compression draught seals are manufactured by Deventer.

The position these are fitted in are as follows:

Service Type	Position
Front door	Rebated into the frame surrounding each opening or non-opening door.
Single or French door	Rebated into the frame surrounding each opening or non-opening door.
Bifolding Door	Rebated into the frame surrounding each opening or non-opening door.

2.3 Glazing

The standard specification of the glazing in our sash windows is specified below.

	Complete Replacement
Internal Pane	4mm Pilkington KA Toughened
Spacer Size	16mm
Spacer Type	Super Spacer
Spacer Colour ²	White
Gas ³	Argon
External Pane	4mm Toughened
U Value ⁴	1.2
Glazing Bars	Single pane with applied bars

The specifications in more detail with calculations from the glass manufacturer follows on the next pages.

² Alternative spacer colours available upon request.

³ Krypton gas available at extra charge.

⁴ Centre pane U Value of the unit.

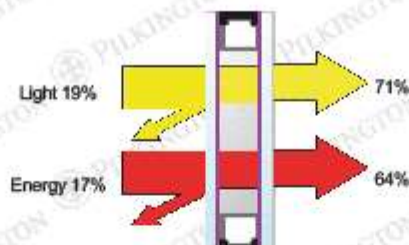

DESCRIPTION

Position	Product	Process	Thickness (nominal) mm	Weight kg/m ²
Pilkington Insulight™ Therm				
Glass 1	Pilkington K Glass™ A	Annealed	4.0	
Cavity 1	Argon (90%)		16.0	
Glass 2	Pilkington K Glass™	Annealed	4.0	
Product Code	4KA-16Ar-K4		24.0	20.00

PERFORMANCE

Light			Energy		
Transmittance	LT	71%	Direct Transmittance	ET	56%
	UV %	33%	Reflectance	ER	17%
Reflectance Out	LR out	19%	Absorptance	EA	26%
Reflectance In	LR in	19%	Total Transmittance	g	64%
Performance Code			Shading Coefficient Total		0.74
U _g -value/Light/Energy		1.2 / 71 / 64	Shading Coefficient Shortwave		0.65
Ra		98	Sound Reduction	R _w (C; C _{tr}) dB	31 (-2; -5)
The values of some of characteristics are displayed as NPD. This stands for No Performance Determined.			Thermal Transmittance	W/m ² K	1.2

Pilkington Spectrum allows you to combine a wide range of products available from Pilkington and determine their key properties such as light transmittance, g value and U value. The program includes restrictions that prevent some combinations being selected that may be considered unwise or impractical. Even with these restrictions, it is still possible to create product combinations that may not be available from your supplier. Please check with your supplier that your chosen product combination is possible, available in the sizes required and in a timescale appropriate to your project. Furthermore, it is essential that you check that your product combination is appropriate for satisfying local, regional, national and other project-specific requirements.

Calculations are made according to EN standards 410 and 673/12898

Pilkington Spectrum Version UK:7.3.1

29/09/2021

2.3.1 Noise Reduction/Acoustic Performance

The acoustic performance of our standard double glazed units are shown on the specifications in the previous pages.

For more information on acoustic performance, please consult our Glass Guide.

2.4 Ironmongery

There is a wide array of ironmongery items and finishes available. Our ironmongery catalogue contains the ironmongery items that we stock as standard, but if you see anything you like online that isn't in the catalogue, just let us know and we can discuss this with you.

The ironmongery for your order will be specified on your quote and Order Confirmation. Ensure you double check that this is exactly what you are hoping for.

3 Section Details

The following pages show standard specification and dimensional details. If you have any questions about this, please ask us and we will be happy to help.

These section details are split into three sections:

- ❖ Front Doors
- ❖ Single & French Doors
- ❖ Bifolding Doors

3.1.1 Section Drawing Overview – Front Doors

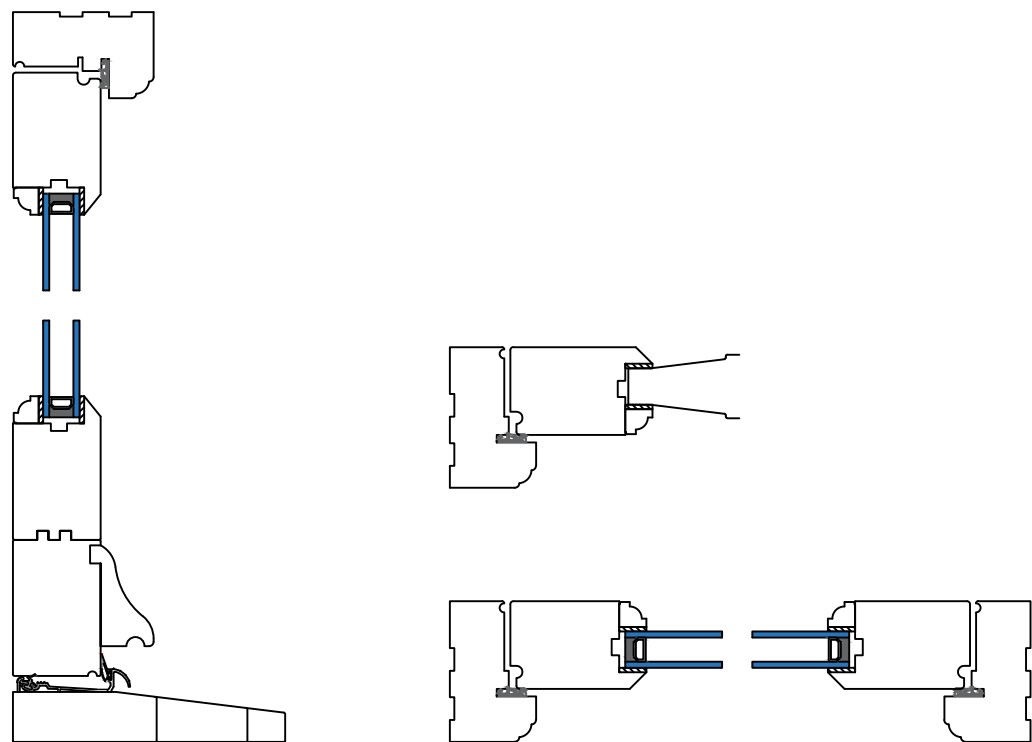

Scale 1:5 @ A4		
Drawn By Nathan Smith		Date Drawn 17.09.2021
<div> Wandsworth Sash Windows</div>		
Unit 2, Kangley Bridge Road, Kangley Business Centre, Lower Sydenham, London, SE265 AQ T: 020 3576 7500 E: sales@wandsworthsashwindows.com		
Drawing Status B-STATUS		
Job No Front Doors	Drawing No 3.1.1	Revision 01

This drawing is prepared to show the standard section profiles and dimensions of products manufactured and supplied by Wandsworth Sash Windows. If dimensions are critical for other trades, please contact us before working from these drawings.

3.1.2 Section Drawing Detailed – Front Doors

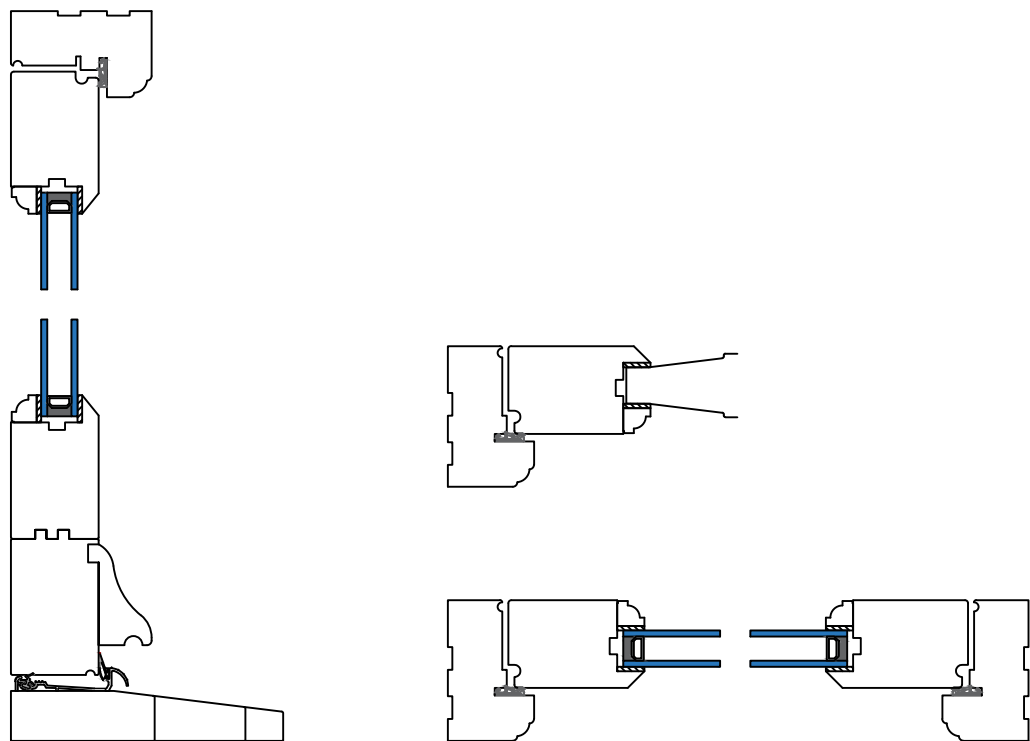

Scale
1:5 @ A4

Drawn By Nathan Smith	Date Drawn 17.09.2021
--------------------------	--------------------------



Unit 2, Kangley Bridge Road,
Kangley Business Centre, Lower Sydenham,
London, SE265 AQ
T: 020 3576 7500
E: sales@wandsworthsashwindows.com

This drawing is prepared to show the standard section profiles and dimensions of products manufactured and supplied by Wandsworth Sash Windows. If dimensions are critical for other trades, please contact us before working from these drawings.

Drawing Status
B-STATUS

Job No Front Doors	Drawing No 3.1.2	Revision 01
-----------------------	---------------------	----------------

3.2.1 Section Drawing Overview – French & Single Doors

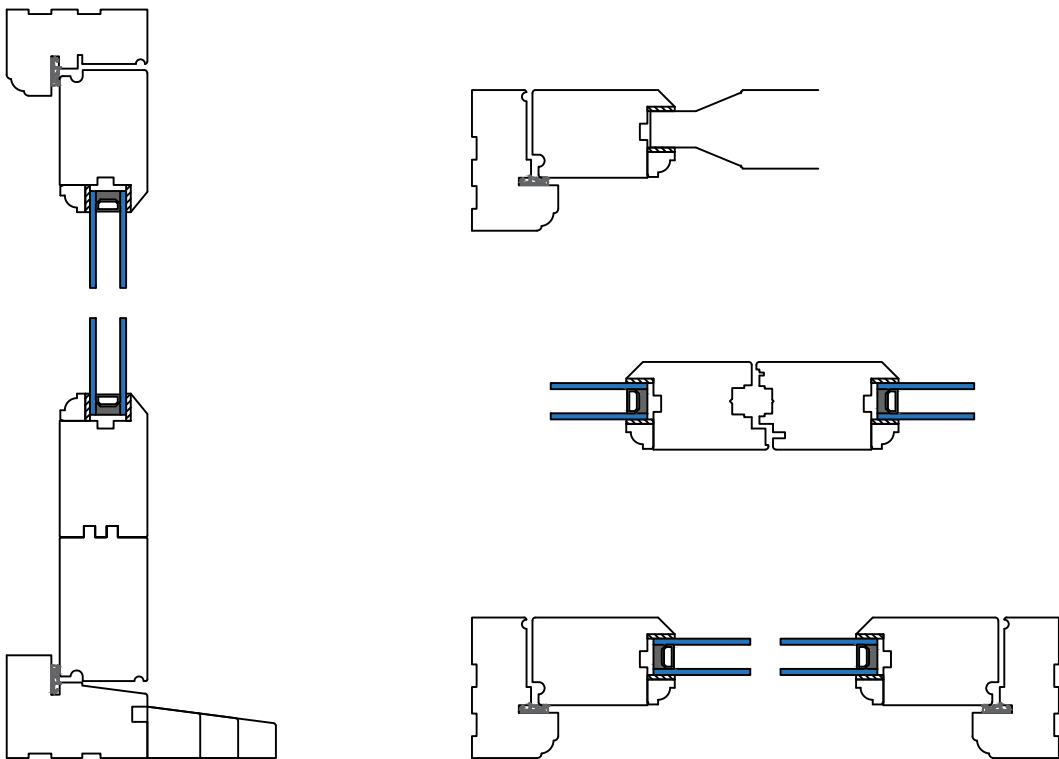

Scale
1:5 @ A4

Drawn By Nathan Smith	Date Drawn 17.09.2021
--------------------------	--------------------------



**Wandsworth
Sash Windows**

Unit 2, Kingley Bridge Road,
Kingley Business Centre, Lower Sydenham,
London, SE265 AQ
T: 020 3576 7500
E: sales@wandsworthsashwindows.com

This drawing is prepared to show the standard section profiles and dimensions of products manufactured and supplied by Wandsworth Sash Windows. If dimensions are critical for other trades, please contact us before working from these drawings.

Drawing Status B-STATUS		
Job No French & Single	Drawing No 3.2.1	Revision 01

3.2.2 Section Drawing Overview – French & Single Doors

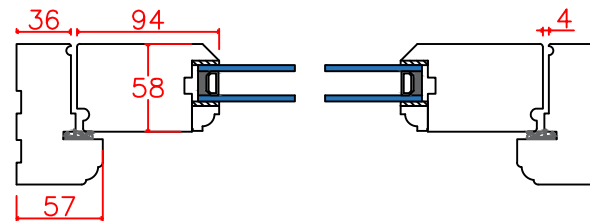
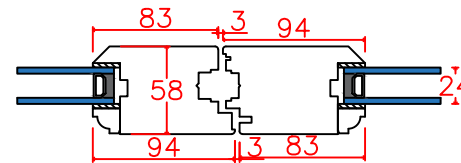
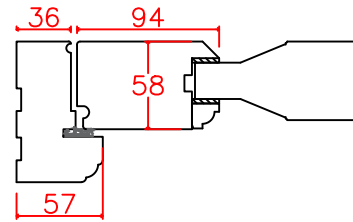
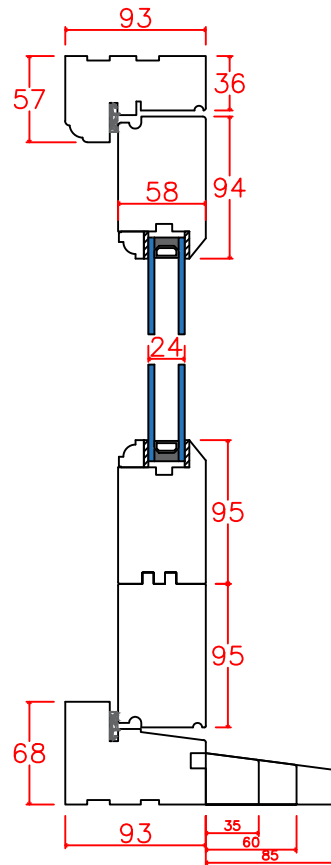

Scale
1:5 @ A4

Drawn By
Nathan Smith

Date Drawn
17.09.2021



Unit 2, Kangley Bridge Road,
Kangley Business Centre, Lower Sydenham,
London, SE26 5AQ
T: 020 3576 7500
E: sales@wandsworthsashwindows.com

Drawing Status
B-STATUS

Job No
French & Single

Drawing No
3.2.1

Revision
01

This drawing is prepared to show the standard section profiles and dimensions of products manufactured and supplied by Wandsworth Sash Windows. If dimensions are critical for other trades, please contact us before working from these drawings.

3.3.1 Section Drawing Overview – Bifolding Doors

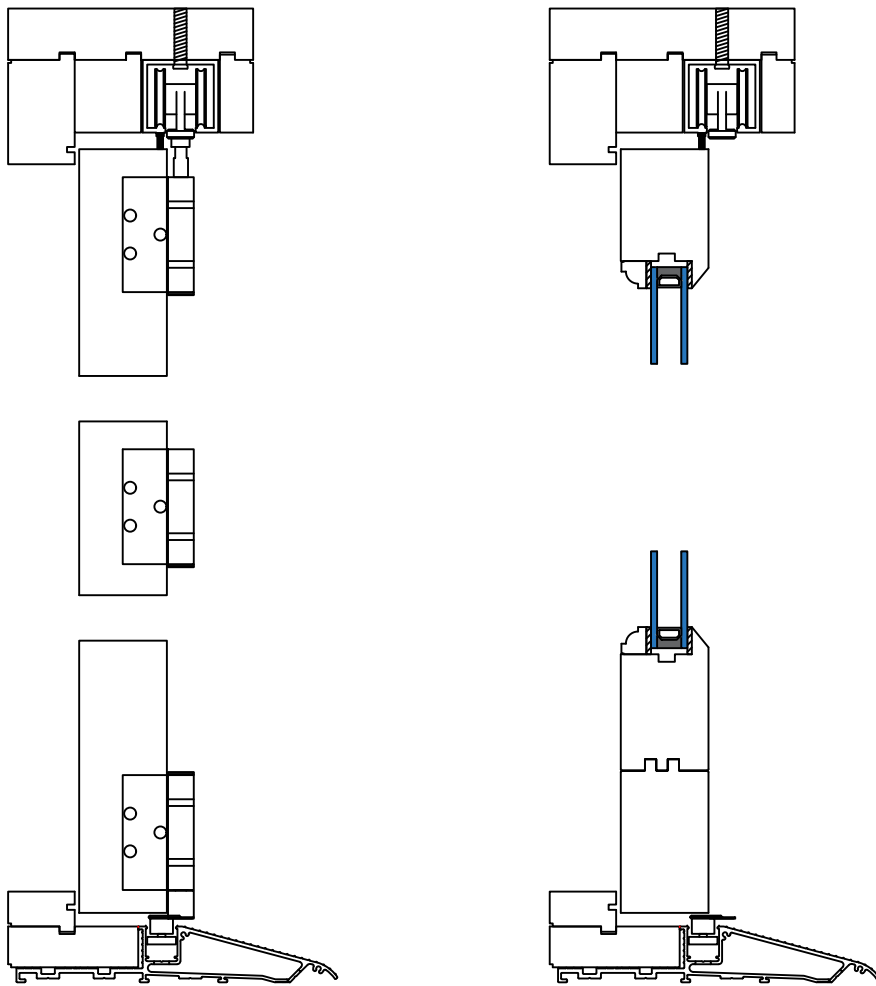

Scale 1:5 @ A4		
Drawn By Nathan Smith		Date Drawn 17.09.2021
<div> Wandsworth Sash Windows</div>		
Unit 2, Kangley Bridge Road, Kangley Business Centre, Lower Sydenham, London, SE265 AQ T: 020 3576 7500 E: sales@wandsworthsashwindows.com		
Drawing Status B-STATUS		
Job No Bifolding Doors	Drawing No 3.3.1	Revision 01

This drawing is prepared to show the standard section profiles and dimensions of products manufactured and supplied by Wandsworth Sash Windows. If dimensions are critical for other trades, please contact us before working from these drawings.

3.3.2 Section Drawing Overview – Bifolding Doors

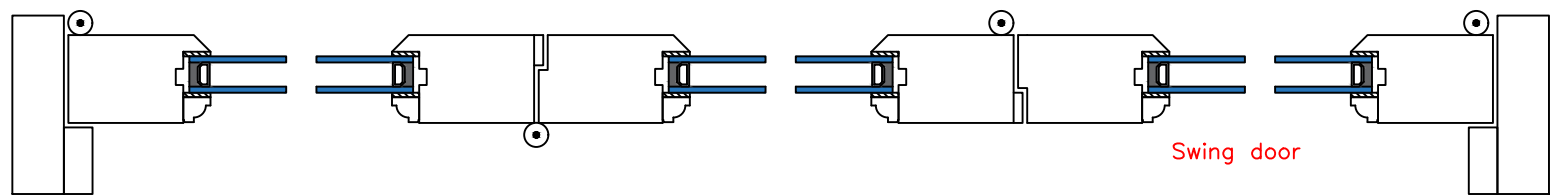

Scale 1:5 @ A4		
Drawn By Nathan Smith		Date Drawn 17.09.2021
<div></div>		
Unit 2, Kangley Bridge Road, Kangley Business Centre, Lower Sydenham, London, SE265 AQ T: 020 3576 7500 E: sales@wandsworthsashwindows.com		
Drawing Status B-STATUS		
Job No Bifolding Doors	Drawing No 3.3.1	Revision 01

This drawing is prepared to show the standard section profiles and dimensions of products manufactured and supplied by Wandsworth Sash Windows. If dimensions are critical for other trades, please contact us before working from these drawings.

3.3.3 Section Drawing Detailed – Bifolding Doors

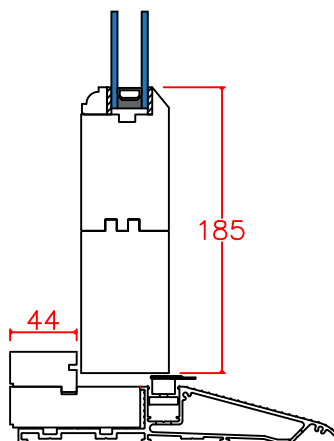
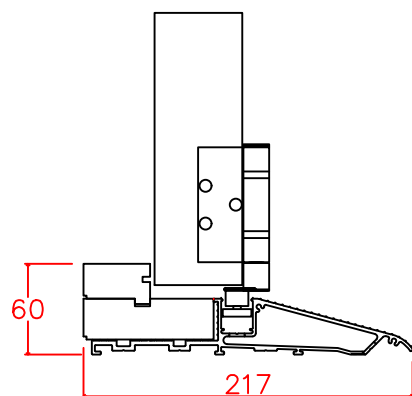
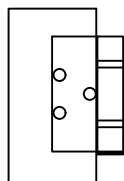
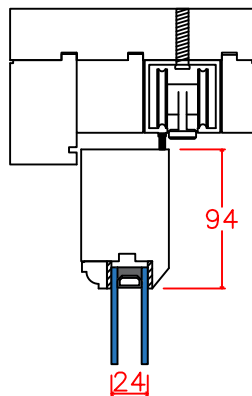
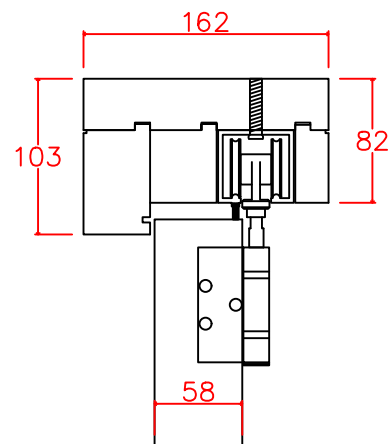

Scale
1:5 @ A4

Drawn By
Nathan Smith

Date Drawn
17.09.2021



Unit 2, Kangley Bridge Road,
Kangley Business Centre, Lower Sydenham,
London, SE26 5AQ
T: 020 3576 7500
E: sales@wandsworthsashwindows.com

Drawing Status

B-STATUS

Job No
Bifolding Doors

Drawing No
3.3.1

Revision
01

This drawing is prepared to show the standard section profiles and dimensions of products manufactured and supplied by Wandsworth Sash Windows. If dimensions are critical for other trades, please contact us before working from these drawings.